

HEX SOCKET CAP SCREW

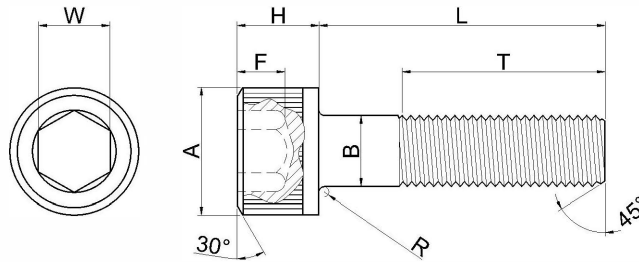

METRIC (KS B1003, JIS B1176)

(UNIT : mm)

Nominal size of threads	B		H		A		W		F	T	R	P
	Basic	Tolerance	Basic	Tolerance	Basic	Tolerance	Basic	Tolerance	Min	Reference	Min	Pitch
M8	8	0	8	0	13	±0.27	6	+0.095	4	28	0.4	1.25
M10	10	-0.22	10	-0.36	16		8	+0.115	5	32	0.4	1.5
M12	12	0	12	0	18		10		6	36	0.6	1.75
M16	16	-0.27	16	-0.43	24	±0.33	14	+0.142	8	44	0.6	2
M20	20	0	20	0	30		17	+0.230	10	52	0.8	2.5
M24	24	-0.33	24	-0.52	36	±0.39	19	+0.275	12	60	0.8	3
M30	30		30		45		22		72	1	3.5	
M36	36	0	36	0	54		27		19	84	1	4
M48	48	-0.39	48	-0.62	72	±0.46	36	+0.330	24	108	1.6	5

UNIFIED (ANSI B18.3)

(UNIT : Inch)

Nominal size of threads		B		H		A		W	F	T	R
		Max	Min	Max	Min	Max	Min	Nom	Min	Min	Min
5/16	0.3125	0.3125	0.3053	0.312	0.306	0.469	0.457	0.250	0.151	1.12	0.009
3/8	0.3750	0.3750	0.3678	0.375	0.368	0.562	0.550	0.312	0.182	1.25	0.012
7/16	0.4375	0.4375	0.4294	0.438	0.430	0.656	0.642	0.375	0.213	1.38	0.014
1/2	0.5000	0.5000	0.4949	0.500	0.492	0.750	0.735	0.375	0.245	1.50	0.016
5/8	0.6250	0.6250	0.6163	0.625	0.616	0.938	0.921	0.500	0.307	1.75	0.021
3/4	0.7500	0.7500	0.7406	0.750	0.740	1.125	1.107	0.625	0.370	2.00	0.025
7/8	0.8750	0.8750	0.8647	0.875	0.864	1.312	1.293	0.750	0.432	2.25	0.031
1	1.0000	1.0000	0.9886	1.000	0.988	1.500	1.479	0.750	0.495	2.50	0.034
1.1/8	1.1250	1.1250	1.1086	1.125	1.111	1.688	1.665	0.875	0.557	2.81	0.039
1.1/4	1.2500	1.2500	1.2336	1.250	1.236	1.875	1.852	0.875	0.620	3.12	0.044
1.3/8	1.3750	1.3750	1.3568	1.375	1.360	2.062	2.038	1.000	0.682	3.44	0.048
1.1/2	1.5000	1.5000	1.4818	1.500	1.485	2.250	2.224	1.000	0.745	3.75	0.052
1.3/4	1.7500	1.7500	1.7295	1.750	1.734	2.625	2.597	1.250	0.870	4.38	0.062
2	2.0000	2.0000	1.9780	2.000	1.983	3.000	2.970	1.500	0.995	5.00	0.071
2.1/4	2.2500	2.2500	2.2280	2.250	2.232	3.375	3.344	1.750	1.120	5.62	0.080
2.1/2	2.5000	2.5000	2.4762	2.500	2.481	3.750	3.717	1.750	1.245	6.25	0.088
2.3/4	2.7500	2.7500	2.7262	2.750	2.730	4.125	4.090	2.000	1.370	6.88	0.097
3	3.0000	3.0000	2.9762	3	2.979	4.500	4.464	2.250	1.495	7.50	0.106